

### ATTENZIONE - ATTENTION - ACHTUNG

- I MOTORIZZATI COD. "DW00150250" E "DW00150140" NON SI POSSONO MONTARE SULLE MACCHINE VT900M/TM-VT1100M. CONTATTARE UFFICIO TECNICO
- THE DRIVEN TOOLS WITH PART NUMBER "DW00150250" AND "DW00150140" CAN NOT BE MOUNTED ON THE FOLLOWING MACHINES: VT900M/TM-VT1100M PLEASE CONTACT OUR TECHNICAL DEPARTMENT
- DIE ANGETRIEBENE WERKZEUGE "DW00150250" UND "DW00150140" KANN MAN NICHT AUF DEN VT900M/TM-VT1100M MASCHINEN MONTIEREN. BITTE DAS TECHNISCHE BUERO KONTAKTIEREN

### ATTENZIONE - ATTENTION - ACHTUNG

- Su macchina VT1100M non arrivano in centro mandrino
- On machine VT1100M tool does not get to the centre of the spindle axis.
- Auf Maschinen VT1100M erreicht das Werkzeug nicht die Mitte der Werkzeug-Achse.

Cod. MT	Cod. EPPINGER	Mandrino Spindel Spindel	I	RPM	Reversibile lato mandrino/contromandrino Reversible sub/main spindle side Umkehrbare Spindel-seite/ Gegenspindel-seite	Lubr.interna Coolant through Innenkuehlung	Lubr. esterna Ext. coolant Aussenkuehlung	A	A1	B	CHIAVI NON INCLUSE Keys not included Schlüssel nicht einbegriffen	
DW00150150	-	ER A 50	1:1	3000	X		X	143.33	-	75	CHUB50	CHUB74
DW00150250	-	ER A 50	1:1	3000	X	P=70bar	X	143.33	-	91	CHUB50	CHUB74
DW00151250	-	ER A 50	1:1	3000	X	P=70bar	X	143.33	-	86	CHUB50	CHUB74
DW00150140	-	Weldon 40	1:1	3000	X	P=70bar	X	-	175.5	91	-	-

NEW

DAEW00 BMT 85

MOD: VT900M/TM - VT1100M - PUMA 600M/LM - PUMA 700M/LM

MODULO MOTORIZZATO ASSIALE

Axial driven tool

Axial angetriebenes Werkzeug

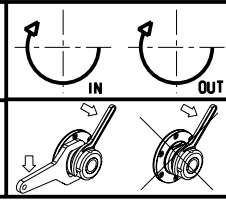

**M.T. srl**

Via dei Tamerici 1/3  
Tel. 0541/956034-957884  
Fax 0541/956341  
47842 S. GIOVANNI IN M. (RN)  
e-mail: mima@mtmarchetti.com  
http://www.mtmarchetti.com

PRODUZIONE MODULI ROTANTI



PAGINA DW0150-5-10