

- Chiave inclusa
- Key included
- Schluessel inbegriffen

Cod. MT	Mandrino Spindle Spindel	I	RPM	Reversibile lato mandrino/contromandrino Reversible sub/main spindle side Umkehrbare Spindel-seite/ Gegenspindel-seite	Lubrificazione int. Coolant through Innenkühlung	Lubrificazione est. Ext. coolant Aussenkühlung	A	A1	D	L	CHIAVI NON INCLUSE Keys not included Schluessel nicht einbegriffen		
											CHUB36	CHSTER32	
MZK0121232	ER32	2:1	3000			X	132.1	-	-	-	CHUB36	CHSTER32	NEW
MZK0122432	ER32	2:1	3000		P=70bar	X	132.1	-	-	-	CHUB36	CHSTER32	NEW
MZK0121227	Ø27x21	2:1	3000			X	-	104	27	21	CHUB36	CH_VTCROCE_M12	NEW

MAZAK

MOD: MP620 12 STAZIONI - MP625 12 STAZIONI - MP6200 12 STAZIONI

MODULO MOTOR. RADIALE DISASSATO 50mm I=2:1

Radial re-directed driven tool 50mm I=2:1

Radial angetr. Werkzeug verschoben um 50mm I=2:1

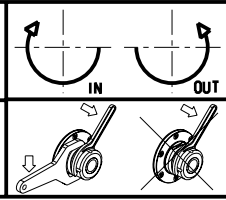

M.T. srl
Via dei Tamerici 1/3
Tel. 0541/956034-957884
Fax 0541/956341
47842 S. GIOVANNI IN M. (RN)
e-mail: mima@mtmarchetti.com
http://www.mtmarchetti.com

PRODUZIONE MODULI ROTANTI



PAGINA MZK030-3-20