

MZK0021132

- Chiave inclusa
- Key included
- Schluessel inbegriffen

Cod. MT	Cod. MAZAK	Mandrino Spindle Spindel	I	RPM	Lubrificazione int. Coolant through Innenkuehlung	Lubrificazione est. Ext. coolant Aussekuehlung	A	B	A1	D	L	H	CHIAVI NON INCLUSE Keys not included Schluessel nicht einbegriffen	
MZK0020132	-	ER32	1:1	4500		X	101.1	58.5	-	-	-	130	CHUB41	CHSTER32
MZK0021032	-	ER32	1:1	4500	P=70bar	X	101.1	82	-	-	-	130	CHUB41	CHSTER32
MZK0021132	-	ER32	1:1	4500		X	101.1	58.5	-	-	-	80	CHUB41	CHSTER32
MZK0020027	-	Ø27x21	1:1	4500		X	-	58.5	78.5	27	21	130	CHUB41	CH_VTCROCE_M12
MZK0020022	-	Ø22x19	1:1	4500		X	-	58.5	78.5	22	19	130	CHUB41	CH_VTCROCE_M10

NEW

MAZAK
 MOD: SQT 15-18M/MS/MY/MSY - SQT200-250M/MS/MY/MSY 12 STAZIONI - QT NEXUS 200-250M/MS/MY/MSY 12 STAZIONI
 MODULO MOTORIZZATO ASSIALE
 Axial driven tool
 Axial angetriebenes. Werkzeug

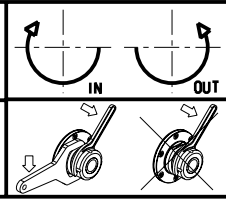

M.T. srl
 Via dei Tamerici 1/3
 Tel. 0541/956034-957884
 Fax 0541/956341
 47842 S. GIOVANNI IN M. (RN)
 e-mail: mima@lmarchetti.com
 http://www.mlmarchetti.com

PRODUZIONE MODULI ROTANTI



PAGINA MZK150-1-20